



Dear business partners,

we have prepared an updated catalogue of chandelier arms and components for you.

Chandelier arms, which serve as a semi product for completion of crystal chandeliers, we produce them from borosilicate glass tubes with diameter 15; 17; 17,4; 17,6; 22; 30 and newly for a great demand with diameter 19 mm. We can create other modifications of section and angles of bending of chandelier arms after a consultation with you.

Axial span of chandelier arms

The distance of axis, which lead in the middle of diameter at the beginning and ending of chandelier arms gives the axial span. This is stated in the designation of chandelier arms and is marked on the technical drawing of every product.

The implementation of the surface of tubes

Smooth profile, deep and smooth profile - straight or twisted.

Surface modification by coating - gold or silver is possible for chandelier arms to maximal axial span 325 mm. Coating is also possible for siliqua and socket cover.

6 deeper slots

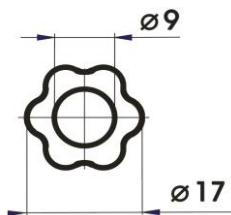

6 fine slots

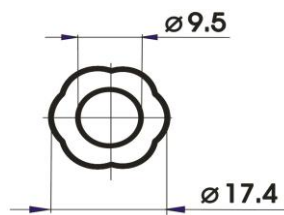

6 star profile

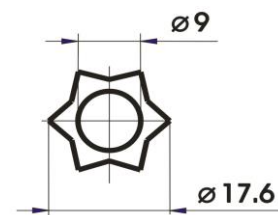

6 deeper slots

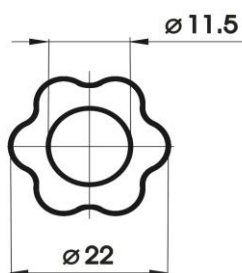

6 fine slots

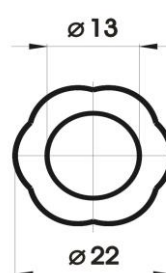

CHANDELIER ARM 105

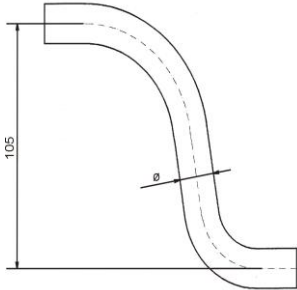

| Code | Outside design | Ø (OD) mm | Drawing SV | Packing (pcs) |
|---|--------------------------------|--------------|---------------|------------------|
| 636 625 010 500 | smooth | 15 | 1518 | 180 |
| 636 625 010 502 | 6 deeper slots (straight) | 17 | 1518/b | 150 |
| 636 625 010 503 | 6 deeper slots (twisted) | 17 | 1518/c | 150 |
| 636 625 010 504 | 6 fine slots (straight) | 17,4 | 1518/d | 150 |
| 636 625 010 505 | 6 fine slots (twisted) | 17,4 | 1518/e | 150 |
| 636 626 010 503 | 6 star profile - deep twisting | 17,6 | 1518/f | 150 |
| 636 626 010 505 | 6 star profile - fine twisting | 17,6 | 1518/g | 150 |
| with GOLD metal caps+electricity | | | | |
| 636 111 010 503 | 6 deeper slots (twisted) | 17 | 1518/c | 100 |
| 636 111 010 505 | 6 fine slots (twisted) | 17,4 | 1518/e | 100 |
| with SILVER metal caps+electricity | | | | |
| 636 112 010 503 | 6 deeper slots (twisted) | 17 | 1518/c | 100 |
| 636 112 010 505 | 6 fine slots (twisted) | 17,4 | 1518/e | 100 |

CHANDELIER ARM 105-1

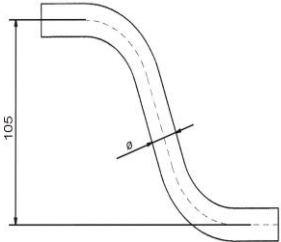

| Code | Outside design | Ø (OD) mm | Drawing SV | Packing (pcs) |
|---|--------------------------------|--------------|---------------|------------------|
| 636 625 110 500 | smooth | 15 | 1529/f | 150 |
| 636 625 110 512 | 6 deeper slots (straight) | 17 | 1529 | 120 |
| 636 625 110 513 | 6 deeper slots (twisted) | 17 | 1529/a | 120 |
| 636 625 110 514 | 6 fine slots (straight) | 17,4 | 1529/b | 120 |
| 636 625 110 515 | 6 fine slots (twisted) | 17,4 | 1529/c | 120 |
| 636 626 110 513 | 6 star profile - deep twisting | 17,6 | 1529/d | 120 |
| 636 626 110 515 | 6 star profile - fine twisting | 17,6 | 1529/e | 120 |
| with GOLD metal caps+electricity | | | | |
| 636 111 110 513 | 6 deeper slots (twisted) | 17 | 1529/a | 100 |
| 636 111 110 515 | 6 fine slots (twisted) | 17,4 | 1529/c | 100 |
| with SILVER metal caps+electricity | | | | |
| 636 112 110 513 | 6 deeper slots (twisted) | 17 | 1529/a | 100 |
| 636 112 110 515 | 6 fine slots (twisted) | 17,4 | 1529/c | 100 |

CHANDELIER ARM U - 115

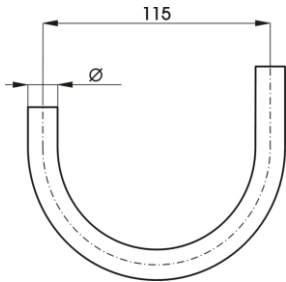

| Code | Outside design | Ø (OD) mm | Drawing SV | Packing (pcs) |
|---|--------------------------------|--------------|---------------|------------------|
| 636 625 011 500 | smooth | 15 | 1519 | 70 |
| 636 625 011 502 | 6 deeper slots (straight) | 17 | 1519/b | 70 |
| 636 625 011 503 | 6 deeper slots (twisted) | 17 | 1519/c | 70 |
| 636 625 011 504 | 6 fine slots (straight) | 17,4 | 1519/d | 70 |
| 636 625 011 505 | 6 fine slots (twisted) | 17,4 | 1519/e | 70 |
| 636 626 011 503 | 6 star profile - deep twisting | 17,6 | 1519/f | 70 |
| 636 626 011 505 | 6 star profile - fine twisting | 17,6 | 1519/g | 70 |
| with GOLD metal caps+electricity | | | | |
| 636 111 011 503 | 6 deeper slots (twisted) | 17 | 1519/c | 60 |
| 636 111 011 505 | 6 fine slots (twisted) | 17,4 | 1519/e | 60 |
| with SILVER metal caps+electricity | | | | |
| 636 112 011 503 | 6 deeper slots (twisted) | 17 | 1519/c | 60 |
| 636 112 011 505 | 6 fine slots (twisted) | 17,4 | 1519/e | 60 |

CHANDELIER ARM 135

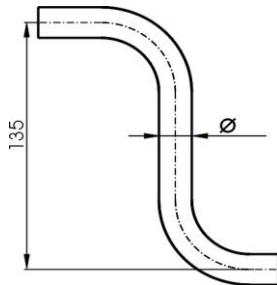

| Code | Outside design | Ø (OD) mm | Drawing SV | Packing (pcs) |
|---|--------------------------------|--------------|---------------|------------------|
| 636 625 013 500 | smooth | 15 | 1343 | 70 |
| 636 625 013 502 | 6 deeper slots (straight) | 17 | 1343/b | 60 |
| 636 625 013 503 | 6 deeper slots (twisted) | 17 | 1343/c | 60 |
| 636 625 013 504 | 6 fine slots (straight) | 17,4 | 1343/d | 60 |
| 636 625 013 505 | 6 fine slots (twisted) | 17,4 | 1343/e | 60 |
| 636 626 013 503 | 6 star profile - deep twisting | 17,6 | 1343/f | 60 |
| 636 626 013 505 | 6 star profile - fine twisting | 17,6 | 1343/g | 60 |
| with GOLD metal caps+electricity | | | | |
| 636 111 013 503 | 6 deeper slots (twisted) | 17 | 1343/c | 40 |
| 636 111 013 505 | 6 fine slots (twisted) | 17,4 | 1343/e | 40 |
| with SILVER metal caps+electricity | | | | |
| 636 112 013 503 | 6 deeper slots (twisted) | 17 | 1343/c | 40 |
| 636 112 013 505 | 6 fine slots (twisted) | 17,4 | 1343/e | 40 |

CHANDELIER ARM S 6" (137 mm)

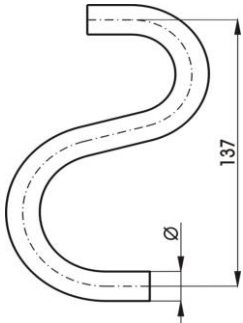

| Code | Outside design | Ø (OD) mm | Drawing SV | Packing (pcs) |
|---|--------------------------------|--------------|---------------|------------------|
| 636 625 013 700 | smooth | 15 | 1520 | 70 |
| 636 625 013 702 | 6 deeper slots (straight) | 17 | 1520/b | 60 |
| 636 625 013 703 | 6 deeper slots (twisted) | 17 | 1520/c | 60 |
| 636 625 013 704 | 6 fine slots (straight) | 17,4 | 1520/d | 60 |
| 636 625 013 705 | 6 fine slots (twisted) | 17,4 | 1520/e | 60 |
| 636 626 013 703 | 6 star profile - deep twisting | 17,6 | 1520/f | 60 |
| 636 626 013 705 | 6 star profile - fine twisting | 17,6 | 1520/g | 60 |
| with GOLD metal caps+electricity | | | | |
| 636 111 013 703 | 6 deeper slots (twisted) | 17 | 1520/c | 40 |
| 636 111 013 705 | 6 fine slots (twisted) | 17,4 | 1520/e | 40 |
| with SILVER metal caps+electricity | | | | |
| 636 112 013 703 | 6 deeper slots (twisted) | 17 | 1520/c | 40 |
| 636 112 013 705 | 6 fine slots (twisted) | 17,4 | 1520/e | 40 |

CHANDELIER ARM 145

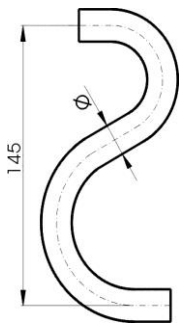

| Code | Outside design | Ø (OD) mm | Drawing SV | Packing (pcs) |
|---|--------------------------------|--------------|---------------|------------------|
| 636 625 014 500 | smooth | 15 | 2309/b | 70 |
| 636 625 014 502 | 6 deeper slots (straight) | 17 | 2309/a | 60 |
| 636 625 014 503 | 6 deeper slots (twisted) | 17 | 2309 | 60 |
| 636 625 014 504 | 6 fine slots (straight) | 17,4 | 2309/d | 60 |
| 636 625 014 505 | 6 fine slots (twisted) | 17,4 | 2309/e | 60 |
| 636 626 014 503 | 6 star profile - deep twisting | 17,6 | 2309/f | 60 |
| 636 626 014 505 | 6 star profile - fine twisting | 17,6 | 2309/g | 60 |
| with GOLD metal caps+electricity | | | | |
| 636 111 014 503 | 6 deeper slots (twisted) | 17 | 2309 | 40 |
| 636 111 014 505 | 6 fine slots (twisted) | 17,4 | 2309/e | 40 |
| with SILVER metal caps+electricity | | | | |
| 636 112 014 503 | 6 deeper slots (twisted) | 17 | 2309 | 40 |
| 636 112 014 505 | 6 fine slots (twisted) | 17,4 | 2309/e | 40 |

CHANDELIER ARM 160

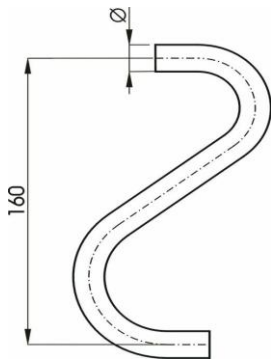

| Code | Outside design | Ø (OD) mm | Drawing SV | Packing (pcs) |
|---|--------------------------------|--------------|---------------|------------------|
| 636 625 016 000 | smooth | 15 | 1521 | 60 |
| 636 625 016 002 | 6 deeper slots (straight) | 17 | 1521/b | 60 |
| 636 625 016 003 | 6 deeper slots (twisted) | 17 | 1521/c | 60 |
| 636 625 016 004 | 6 fine slots (straight) | 17,4 | 1521/d | 60 |
| 636 625 016 005 | 6 fine slots (twisted) | 17,4 | 1521/e | 60 |
| 636 626 016 003 | 6 star profile - deep twisting | 17,6 | 1521/h | 60 |
| 636 626 016 005 | 6 star profile - fine twisting | 17,6 | 1521/ch | 60 |
| 636 625 016 022 | 6 deeper slots (straight) | 22 | 1521/k | 50 |
| 636 625 016 023 | 6 deeper slots (twisted) | 22 | 1521/l | 50 |
| 636 625 016 024 | 6 fine slots (straight) | 22 | 1521/m | 50 |
| 636 625 016 025 | 6 fine slots (twisted) | 22 | 1521/n | 50 |
| with GOLD metal caps+electricity | | | | |
| 636 111 016 003 | 6 deeper slots (twisted) | 17 | 1521/c | 40 |
| 636 111 016 005 | 6 fine slots (twisted) | 17,4 | 1521/e | 40 |
| 636 121 016 023 | 6 deeper slots (twisted) | 22 | 1521/l | 30 |
| 636 121 016 025 | 6 fine slots (twisted) | 22 | 1521/n | 30 |
| with SILVER metal caps+electricity | | | | |
| 636 112 016 003 | 6 deeper slots (twisted) | 17 | 1521/c | 40 |
| 636 112 016 005 | 6 fine slots (twisted) | 17,4 | 1521/e | 40 |
| 636 122 016 023 | 6 deeper slots (twisted) | 22 | 1521/l | 30 |
| 636 122 016 025 | 6 fine slots (twisted) | 22 | 1521/n | 30 |

CHANDELIER ARM 180

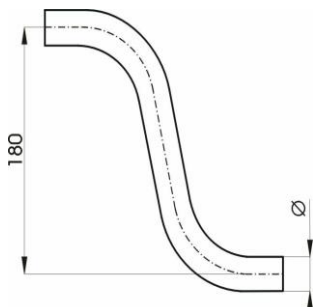

| Code | Outside design | Ø (OD) mm | Drawing SV | Packing (pcs) |
|---|--------------------------------|--------------|---------------|------------------|
| 636 625 018 000 | smooth | 15 | 1522 | 70 |
| 636 625 018 002 | 6 deeper slots (straight) | 17 | 1522/b | 70 |
| 636 625 018 003 | 6 deeper slots (twisted) | 17 | 1522/c | 70 |
| 636 625 018 004 | 6 fine slots (straight) | 17,4 | 1522/d | 70 |
| 636 625 018 005 | 6 fine slots (twisted) | 17,4 | 1522/e | 70 |
| 636 626 018 003 | 6 star profile - deep twisting | 17,6 | 1522/f | 70 |
| 636 626 018 005 | 6 star profile - fine twisting | 17,6 | 1522/g | 70 |
| 636 625 118 002 | 6 deeper slots (straight) | 22 | 2446/b | 50 |
| 636 625 118 003 | 6 deeper slots (twisted) | 22 | 2446/a | 50 |
| 636 625 118 004 | 6 fine slots (straight) | 22 | 2446/c | 50 |
| 636 625 118 005 | 6 fine slots (twisted) | 22 | 2446 | 50 |
| with GOLD metal caps+electricity | | | | |
| 636 111 018 003 | 6 deeper slots (twisted) | 17 | 1522/c | 50 |
| 636 111 018 005 | 6 fine slots (twisted) | 17,4 | 1522/e | 50 |
| 636 121 118 003 | 6 deeper slots (twisted) | 22 | 2446/a | 35 |
| 636 121 118 005 | 6 fine slots (twisted) | 22 | 2446 | 35 |
| with SILVER metal caps+electricity | | | | |
| 636 112 018 003 | 6 deeper slots (twisted) | 17 | 1522/c | 50 |
| 636 112 018 005 | 6 fine slots (twisted) | 17,4 | 1522/e | 50 |
| 636 122 118 003 | 6 deeper slots (twisted) | 22 | 2446/a | 35 |
| 636 122 118 005 | 6 fine slots (twisted) | 22 | 2446 | 35 |

CHANDELIER ARM S 8" (185 mm)

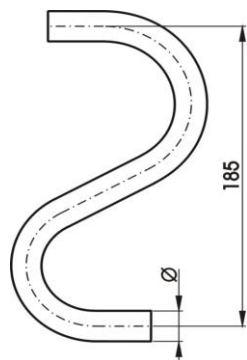

| Code | Outside design | Ø (OD) mm | Drawing SV | Packing (pcs) |
|---|--------------------------------|--------------|---------------|------------------|
| 636 625 018 500 | smooth | 15 | 1523 | 70 |
| 636 625 018 502 | 6 deeper slots (straight) | 17 | 1523/b | 60 |
| 636 625 018 503 | 6 deeper slots (twisted) | 17 | 1523/c | 60 |
| 636 625 018 504 | 6 fine slots (straight) | 17,4 | 1523/d | 60 |
| 636 625 018 505 | 6 fine slots (twisted) | 17,4 | 1523/e | 60 |
| 636 626 018 503 | 6 star profile - deep twisting | 17,6 | 1523/f | 60 |
| 636 626 018 505 | 6 star profile - fine twisting | 17,6 | 1523/g | 60 |
| 636 625 018 522 | 6 deeper slots (straight) | 22 | 1523/h | 50 |
| 636 625 018 523 | 6 deeper slots (twisted) | 22 | 1523/ch | 50 |
| 636 625 018 524 | 6 fine slots (straight) | 22 | 1523/i | 50 |
| 636 625 018 525 | 6 fine slots (twisted) | 22 | 1523/j | 50 |
| with GOLD metal caps+electricity | | | | |
| 636 111 018 503 | 6 deeper slots (twisted) | 17 | 1523/c | 50 |
| 636 111 018 505 | 6 fine slots (twisted) | 17,4 | 1523/e | 50 |
| 636 121 018 523 | 6 deeper slots (twisted) | 22 | 1523/ch | 35 |
| 636 121 018 525 | 6 fine slots (twisted) | 22 | 1523/j | 35 |
| with SILVER metal caps+electricity | | | | |
| 636 112 018 503 | 6 deeper slots (twisted) | 17 | 1523/c | 50 |
| 636 112 018 505 | 6 fine slots (twisted) | 17,4 | 1523/e | 50 |
| 636 122 018 523 | 6 deeper slots (twisted) | 22 | 1523/ch | 35 |
| 636 122 018 525 | 6 fine slots (twisted) | 22 | 1523/j | 35 |

CHANDELIER ARM 190

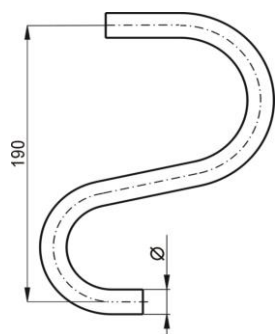

| Code | Outside design | Ø (OD) mm | Drawing SV | Packing (pcs) |
|---|--------------------------------|--------------|---------------|------------------|
| 636 625 119 000 | smooth | 15 | 1530/i | 60 |
| 636 625 119 002 | 6 deeper slots (straight) | 17 | 1530 | 60 |
| 636 625 119 003 | 6 deeper slots (twisted) | 17 | 1530/a | 60 |
| 636 625 119 004 | 6 fine slots (straight) | 17,4 | 1530/b | 60 |
| 636 625 119 005 | 6 fine slots (twisted) | 17,4 | 1530/c | 60 |
| 636 626 119 003 | 6 star profile - deep twisting | 17,6 | 1530/d | 60 |
| 636 626 119 005 | 6 star profile - fine twisting | 17,6 | 1530/e | 60 |
| 636 625 119 022 | 6 deeper slots (straight) | 22 | 1530/f | 40 |
| 636 625 119 023 | 6 deeper slots (twisted) | 22 | 1530/g | 40 |
| 636 625 119 024 | 6 fine slots (straight) | 22 | 1530/h | 40 |
| 636 625 119 025 | 6 fine slots (twisted) | 22 | 1530/ch | 40 |
| with GOLD metal caps+electricity | | | | |
| 636 111 119 003 | 6 deeper slots (twisted) | 17 | 1530/a | 50 |
| 636 111 119 005 | 6 fine slots (twisted) | 17,4 | 1530/c | 50 |
| 636 121 119 023 | 6 deeper slots (twisted) | 22 | 1530/g | 30 |
| 636 121 119 025 | 6 fine slots (twisted) | 22 | 1530/ch | 30 |
| with SILVER metal caps+electricity | | | | |
| 636 112 119 003 | 6 deeper slots (twisted) | 17 | 1530/a | 50 |
| 636 112 119 005 | 6 fine slots (twisted) | 17,4 | 1530/c | 50 |
| 636 122 119 023 | 6 deeper slots (twisted) | 22 | 1530/g | 30 |
| 636 122 119 025 | 6 fine slots (twisted) | 22 | 1530/ch | 30 |

CHANDELIER ARM 195

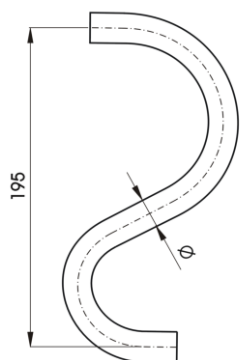

| Code | Outside design | Ø (OD) mm | Drawing SV | Packing (pcs) |
|---|--------------------------------|--------------|---------------|------------------|
| 636 625 019 500 | smooth | 15 | 1524 | 60 |
| 636 625 019 502 | 6 deeper slots (straight) | 17 | 1524/b | 60 |
| 636 625 019 503 | 6 deeper slots (twisted) | 17 | 1524/c | 60 |
| 636 625 019 504 | 6 fine slots (straight) | 17,4 | 1524/d | 60 |
| 636 625 019 505 | 6 fine slots (twisted) | 17,4 | 1524/e | 60 |
| 636 626 019 503 | 6 star profile - deep twisting | 17,6 | 1524/h | 60 |
| 636 626 019 505 | 6 star profile - fine twisting | 17,6 | 1524/ch | 60 |
| 636 625 019 522 | 6 deeper slots (straight) | 22 | 2444/b | 40 |
| 636 625 019 523 | 6 deeper slots (twisted) | 22 | 2444/a | 40 |
| 636 625 019 524 | 6 fine slots (straight) | 22 | 2444/c | 40 |
| 636 625 019 525 | 6 fine slots (twisted) | 22 | 2444 | 40 |
| with GOLD metal caps+electricity | | | | |
| 636 111 019 503 | 6 deeper slots (twisted) | 17 | 1524/c | 50 |
| 636 111 019 505 | 6 fine slots (twisted) | 17,4 | 1524/e | 50 |
| 636 121 019 523 | 6 deeper slots (twisted) | 22 | 2444/a | 30 |
| 636 121 019 525 | 6 fine slots (twisted) | 22 | 2444 | 30 |
| with SILVER metal caps+electricity | | | | |
| 636 112 019 503 | 6 deeper slots (twisted) | 17 | 1524/c | 50 |
| 636 112 019 505 | 6 fine slots (twisted) | 17,4 | 1524/e | 50 |
| 636 122 019 523 | 6 deeper slots (twisted) | 22 | 2444/a | 30 |
| 636 122 019 525 | 6 fine slots (twisted) | 22 | 2444 | 30 |

CHANDELIER ARM U - 195

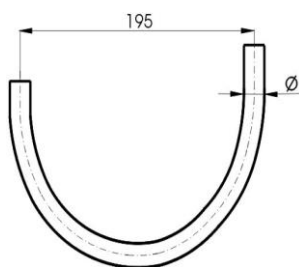

| Code | Outside design | Ø (OD) mm | Drawing SV | Packing (pcs) |
|---|--------------------------------|--------------|---------------|------------------|
| 636 625 019 512 | 6 deeper slots (straight) | 17 | 2352/a | 60 |
| 636 625 019 513 | 6 deeper slots (twisted) | 17 | 2352/b | 60 |
| 636 625 019 514 | 6 fine slots (straight) | 17,4 | 2352/c | 60 |
| 636 625 019 515 | 6 fine slots (twisted) | 17,4 | 2352 | 60 |
| 636 626 019 513 | 6 star profile - deep twisting | 17,6 | 2352/d | 60 |
| 636 626 019 515 | 6 star profile - fine twisting | 17,6 | 2352/e | 60 |
| with GOLD metal caps+electricity | | | | |
| 636 111 019 513 | 6 deeper slots (twisted) | 17 | 2352/b | 50 |
| 636 111 019 515 | 6 fine slots (twisted) | 17,4 | 2352 | 50 |
| with SILVER metal caps+electricity | | | | |
| 636 112 019 513 | 6 deeper slots (twisted) | 17 | 2352/b | 50 |
| 636 112 019 515 | 6 fine slots (twisted) | 17,4 | 2352 | 50 |

CHANDELIER ARM 205

| Code | Outside design | Ø (OD) mm | Drawing SV | Packing (pcs) |
|---|---------------------------|--------------|---------------|------------------|
| 636 625 205 100 | smooth | 15 | 5871 | 70 |
| 636 625 205 112 | 6 deeper slots (straight) | 17 | 5871/b | 70 |
| 636 625 205 113 | 6 deeper slots (twisted) | 17 | 5871/c | 70 |
| 636 625 205 114 | 6 fine slots (straight) | 17,4 | 5871/d | 70 |
| 636 625 205 115 | 6 fine slots (twisted) | 17,4 | 5871/e | 70 |
| 636 625 205 102 | 6 deeper slots (straight) | 22 | 5871/f | 50 |
| 636 625 205 103 | 6 deeper slots (twisted) | 22 | 5871/g | 50 |
| 636 625 205 104 | 6 fine slots (straight) | 22 | 5871/h | 50 |
| 636 625 205 105 | 6 fine slots (twisted) | 22 | 5871/ch | 50 |
| with GOLD metal caps+electricity | | | | |
| 636 111 205 113 | 6 deeper slots (twisted) | 17 | 5871/c | 60 |
| 636 111 205 115 | 6 fine slots (twisted) | 17,4 | 5871/e | 60 |
| 636 121 205 103 | 6 deeper slots (twisted) | 22 | 5871/g | 40 |
| 636 121 205 105 | 6 fine slots (twisted) | 22 | 5871/ch | 40 |
| with SILVER metal caps+electricity | | | | |
| 636 112 205 113 | 6 deeper slots (twisted) | 17 | 5871/c | 60 |
| 636 112 205 115 | 6 fine slots (twisted) | 17,4 | 5871/e | 60 |
| 636 122 205 103 | 6 deeper slots (twisted) | 22 | 5871/g | 40 |
| 636 122 205 105 | 6 fine slots (twisted) | 22 | 5871/ch | 40 |

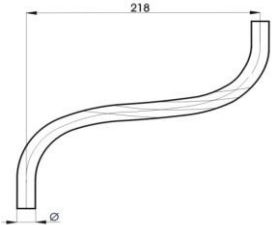

CHANDELIER ARM 205 - 1

| Code | Outside design | Ø (OD) mm | Drawing SV | Packing (pcs) |
|---|---------------------------|--------------|---------------|------------------|
| 636 625 205 000 | smooth | 15 | 1059/g | 70 |
| 636 625 205 012 | 6 deeper slots (straight) | 17 | 1059/ch | 70 |
| 636 625 205 013 | 6 deeper slots (twisted) | 17 | 1059/f | 70 |
| 636 625 205 014 | 6 fine slots (straight) | 17,4 | 1059/d | 70 |
| 636 625 205 015 | 6 fine slots (twisted) | 17,4 | 1059/e | 70 |
| 636 625 205 002 | 6 deeper slots (straight) | 22 | 1059/b | 50 |
| 636 625 205 003 | 6 deeper slots (twisted) | 22 | 1059/a | 50 |
| 636 625 205 004 | 6 fine slots (straight) | 22 | 1059/c | 50 |
| 636 625 205 005 | 6 fine slots (twisted) | 22 | 1059 | 50 |
| with GOLD metal caps+electricity | | | | |
| 636 111 205 013 | 6 deeper slots (twisted) | 17 | 1059/f | 60 |
| 636 111 205 015 | 6 fine slots (twisted) | 17,4 | 1059/e | 60 |
| 636 121 205 003 | 6 deeper slots (twisted) | 22 | 1059/a | 40 |
| 636 121 205 005 | 6 fine slots (twisted) | 22 | 1059 | 40 |
| with SILVER metal caps+electricity | | | | |
| 636 112 205 013 | 6 deeper slots (twisted) | 17 | 1059/f | 60 |
| 636 112 205 015 | 6 fine slots (twisted) | 17,4 | 1059/e | 60 |
| 636 122 205 003 | 6 deeper slots (twisted) | 22 | 1059/a | 40 |
| 636 122 205 005 | 6 fine slots (twisted) | 22 | 1059 | 40 |

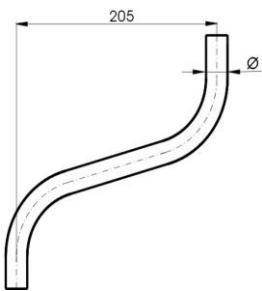

CHANDELIER ARM 220

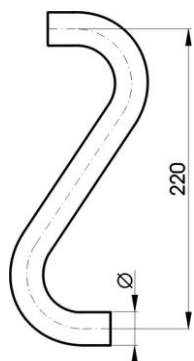

| Code | Outside design | Ø (OD) mm | Drawing SV | Packing (pcs) |
|---|--------------------------------|--------------|---------------|------------------|
| 636 625 022 000 | smooth | 15 | 1525 | 70 |
| 636 625 022 002 | 6 deeper slots (straight) | 17 | 1525/b | 60 |
| 636 625 022 003 | 6 deeper slots (twisted) | 17 | 1525/c | 60 |
| 636 625 022 004 | 6 fine slots (straight) | 17,4 | 1525/d | 60 |
| 636 625 022 005 | 6 fine slots (twisted) | 17,4 | 1525/e | 60 |
| 636 626 022 003 | 6 star profile - deep twisting | 17,6 | 1525/f | 60 |
| 636 626 022 005 | 6 star profile - fine twisting | 17,6 | 1525/g | 60 |
| 636 625 022 062 | 6 deeper slots (straight) | 22 | 1525/k | 50 |
| 636 625 022 063 | 6 deeper slots (twisted) | 22 | 1525/l | 50 |
| 636 625 022 064 | 6 fine slots (straight) | 22 | 1525/m | 50 |
| 636 625 022 065 | 6 fine slots (twisted) | 22 | 1525/n | 50 |
| with GOLD metal caps+electricity | | | | |
| 636 111 022 003 | 6 deeper slots (twisted) | 17 | 1525/c | 50 |
| 636 111 022 005 | 6 fine slots (twisted) | 17,4 | 1525/e | 50 |
| 636 121 022 063 | 6 deeper slots (twisted) | 22 | 1525/l | 40 |
| 636 121 022 065 | 6 fine slots (twisted) | 22 | 1525/n | 40 |
| with SILVER metal caps+electricity | | | | |
| 636 112 022 003 | 6 deeper slots (twisted) | 17 | 1525/c | 50 |
| 636 112 022 005 | 6 fine slots (twisted) | 17,4 | 1525/e | 50 |
| 636 122 022 063 | 6 deeper slots (twisted) | 22 | 1525/l | 40 |
| 636 122 022 065 | 6 fine slots (twisted) | 22 | 1525/n | 40 |

CHANDELIER ARM 220/LG

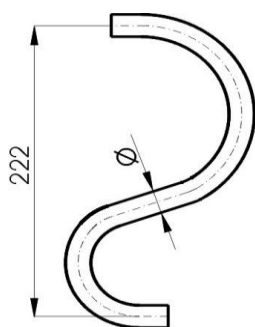

| Code | Outside design | Ø (OD) mm | Drawing SV | Packing (pcs) |
|---|--------------------------------|--------------|---------------|------------------|
| 636 625 022 010 | smooth | 15 | 1346/d | 70 |
| 636 625 022 012 | 6 deeper slots (straight) | 17 | 1346/c | 60 |
| 636 625 022 013 | 6 deeper slots (twisted) | 17 | 1346/a | 60 |
| 636 625 022 014 | 6 fine slots (straight) | 17,4 | 1346/b | 60 |
| 636 625 022 015 | 6 fine slots (twisted) | 17,4 | 1346 | 60 |
| 636 626 022 013 | 6 star profile - deep twisting | 17,6 | 1346/f | 60 |
| 636 626 022 015 | 6 star profile - fine twisting | 17,6 | 1346/g | 60 |
| 636 625 022 072 | 6 deeper slots (straight) | 22 | 1346/ch | 50 |
| 636 625 022 073 | 6 deeper slots (twisted) | 22 | 1346/i | 50 |
| 636 625 022 074 | 6 fine slots (straight) | 22 | 1346/j | 50 |
| 636 625 022 075 | 6 fine slots (twisted) | 22 | 1346/k | 50 |
| with GOLD metal caps+electricity | | | | |
| 636 111 022 013 | 6 deeper slots (twisted) | 17 | 1346/a | 50 |
| 636 111 022 015 | 6 fine slots (twisted) | 17,4 | 1346 | 50 |
| 636 121 022 073 | 6 deeper slots (twisted) | 22 | 1346/i | 40 |
| 636 121 022 075 | 6 fine slots (twisted) | 22 | 1346/k | 40 |
| with SILVER metal caps+electricity | | | | |
| 636 112 022 013 | 6 deeper slots (twisted) | 17 | 1346/a | 50 |
| 636 112 022 015 | 6 fine slots (twisted) | 17,4 | 1346 | 50 |
| 636 122 022 073 | 6 deeper slots (twisted) | 22 | 1346/i | 40 |
| 636 122 022 075 | 6 fine slots (twisted) | 22 | 1346/k | 40 |

CHANDELIER ARM 230

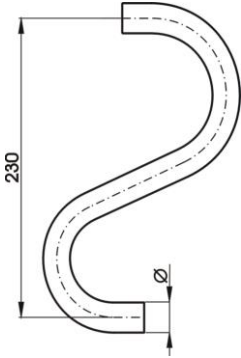

| Code | Outside design | Ø (OD) mm | Drawing SV | Packing (pcs) |
|---|--------------------------------|--------------|---------------|------------------|
| 636 625 123 000 | smooth | 15 | 1531 | 120 |
| 636 625 123 002 | 6 deeper slots (straight) | 17 | 1531/a | 120 |
| 636 625 123 003 | 6 deeper slots (twisted) | 17 | 1531/b | 120 |
| 636 625 123 004 | 6 fine slots (straight) | 17,4 | 1531/c | 120 |
| 636 625 123 005 | 6 fine slots (twisted) | 17,4 | 1531/d | 120 |
| 636 626 123 003 | 6 star profile - deep twisting | 17,6 | 1531/e | 120 |
| 636 626 123 005 | 6 star profile - fine twisting | 17,6 | 1531/f | 120 |
| 636 625 123 012 | 6 deeper slots (straight) | 22 | 1531/h | 100 |
| 636 625 123 013 | 6 deeper slots (twisted) | 22 | 1531/ch | 100 |
| 636 625 123 014 | 6 fine slots (straight) | 22 | 1531/i | 100 |
| 636 625 123 015 | 6 fine slots (twisted) | 22 | 1531/j | 100 |
| with GOLD metal caps+electricity | | | | |
| 636 111 123 003 | 6 deeper slots (twisted) | 17 | 1531/b | 100 |
| 636 111 123 005 | 6 fine slots (twisted) | 17,4 | 1531/d | 100 |
| 636 121 123 013 | 6 deeper slots (twisted) | 22 | 1531/ch | 80 |
| 636 121 123 015 | 6 fine slots (twisted) | 22 | 1531/j | 80 |
| with SILVER metal caps+electricity | | | | |
| 636 112 123 003 | 6 deeper slots (twisted) | 17 | 1531/b | 100 |
| 636 112 123 005 | 6 fine slots (twisted) | 17,4 | 1531/d | 100 |
| 636 122 123 013 | 6 deeper slots (twisted) | 22 | 1531/ch | 80 |
| 636 122 123 015 | 6 fine slots (twisted) | 22 | 1531/j | 80 |

CHANDELIER ARM S 10" (232 mm)

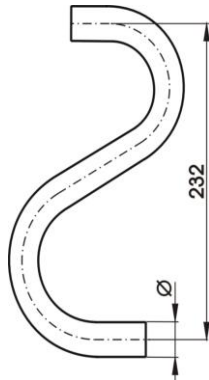

| Code | Outside design | Ø (OD) mm | Drawing SV | Packing (pcs) |
|---|--------------------------------|--------------|---------------|------------------|
| 636 625 023 200 | smooth | 15 | 1526 | 140 |
| 636 625 023 202 | 6 deeper slots (straight) | 17 | 1526/b | 140 |
| 636 625 023 203 | 6 deeper slots (twisted) | 17 | 1526/c | 140 |
| 636 625 023 204 | 6 fine slots (straight) | 17,4 | 1526/d | 140 |
| 636 625 023 205 | 6 fine slots (twisted) | 17,4 | 1526/e | 140 |
| 636 626 023 203 | 6 star profile - deep twisting | 17,6 | 1526/ch | 140 |
| 636 626 023 205 | 6 star profile - fine twisting | 17,6 | 1526/i | 140 |
| 636 625 023 222 | 6 deeper slots (straight) | 22 | 2443/b | 120 |
| 636 625 023 223 | 6 deeper slots (twisted) | 22 | 2443/a | 120 |
| 636 625 023 224 | 6 fine slots (straight) | 22 | 2443/c | 120 |
| 636 625 023 225 | 6 fine slots (twisted) | 22 | 2443 | 120 |
| with GOLD metal caps+electricity | | | | |
| 636 111 023 203 | 6 deeper slots (twisted) | 17 | 1526/c | 120 |
| 636 111 023 205 | 6 fine slots (twisted) | 17,4 | 1526/e | 120 |
| 636 121 023 223 | 6 deeper slots (twisted) | 22 | 2443/a | 100 |
| 636 121 023 225 | 6 fine slots (twisted) | 22 | 2443 | 100 |
| with SILVER metal caps+electricity | | | | |
| 636 112 023 203 | 6 deeper slots (twisted) | 17 | 1526/c | 120 |
| 636 112 023 205 | 6 fine slots (twisted) | 17,4 | 1526/e | 120 |
| 636 122 023 223 | 6 deeper slots (twisted) | 22 | 2443/a | 100 |
| 636 122 023 225 | 6 fine slots (twisted) | 22 | 2443 | 100 |

CHANDELIER ARM 260

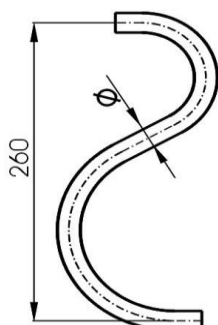

| Code | Outside design | Ø (OD) mm | Drawing SV | Packing (pcs) |
|---|--------------------------------|--------------|---------------|------------------|
| 636 625 026 000 | smooth | 15 | 2311/b | 100 |
| 636 625 026 002 | 6 deeper slots (straight) | 17 | 2311/a | 100 |
| 636 625 026 003 | 6 deeper slots (twisted) | 17 | 2311 | 100 |
| 636 625 026 004 | 6 fine slots (straight) | 17,4 | 2311/d | 100 |
| 636 625 026 005 | 6 fine slots (twisted) | 17,4 | 2311/e | 100 |
| 636 626 026 003 | 6 star profile - deep twisting | 17,6 | 2311/f | 100 |
| 636 626 026 005 | 6 star profile - fine twisting | 17,6 | 2311/g | 100 |
| 636 625 026 022 | 6 deeper slots (straight) | 22 | 2311/h | 80 |
| 636 625 026 023 | 6 deeper slots (twisted) | 22 | 2311/ch | 80 |
| 636 625 026 024 | 6 fine slots (straight) | 22 | 2311/i | 80 |
| 636 625 026 025 | 6 fine slots (twisted) | 22 | 2311/j | 80 |
| with GOLD metal caps+electricity | | | | |
| 636 111 026 003 | 6 deeper slots (twisted) | 17 | 2311 | 90 |
| 636 111 026 005 | 6 fine slots (twisted) | 17,4 | 2311/e | 90 |
| 636 121 026 023 | 6 deeper slots (twisted) | 22 | 2311/ch | 70 |
| 636 121 026 025 | 6 fine slots (twisted) | 22 | 2311/j | 70 |
| with SILVER metal caps+electricity | | | | |
| 636 112 026 003 | 6 deeper slots (twisted) | 17 | 2311 | 90 |
| 636 112 026 005 | 6 fine slots (twisted) | 17,4 | 2311/e | 90 |
| 636 122 026 023 | 6 deeper slots (twisted) | 22 | 2311/ch | 70 |
| 636 122 026 025 | 6 fine slots (twisted) | 22 | 2311/j | 70 |

CHANDELIER ARM S 12" (281 mm)

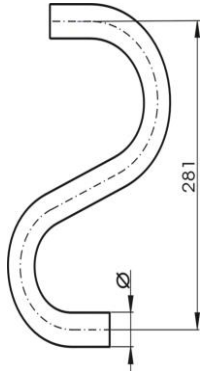

| Code | Outside design | Ø (OD) mm | Drawing SV | Packing (pcs) |
|---|--------------------------------|--------------|---------------|------------------|
| 636 625 028 100 | smooth | 15 | 1527 | 100 |
| 636 625 028 102 | 6 deeper slots (straight) | 17 | 1527/b | 100 |
| 636 625 028 103 | 6 deeper slots (twisted) | 17 | 1527/c | 100 |
| 636 625 028 104 | 6 fine slots (straight) | 17,4 | 1527/d | 90 |
| 636 625 028 105 | 6 fine slots (twisted) | 17,4 | 1527/e | 90 |
| 636 626 028 103 | 6 star profile - deep twisting | 17,6 | 1527/f | 100 |
| 636 626 028 105 | 6 star profile - fine twisting | 17,6 | 1527/g | 90 |
| 636 625 028 112 | 6 deeper slots (straight) | 22 | 3966 | 80 |
| 636 625 028 113 | 6 deeper slots (twisted) | 22 | 3966/b | 80 |
| 636 625 028 114 | 6 fine slots (straight) | 22 | 3966/a | 80 |
| 636 625 028 115 | 6 fine slots (twisted) | 22 | 3966/c | 80 |
| with GOLD metal caps+electricity | | | | |
| 636 111 028 103 | 6 deeper slots (twisted) | 17 | 1527/c | 80 |
| 636 111 028 105 | 6 fine slots (twisted) | 17,4 | 1527/e | 80 |
| 636 121 028 113 | 6 deeper slots (twisted) | 22 | 3966/b | 70 |
| 636 121 028 115 | 6 fine slots (twisted) | 22 | 3966/c | 70 |
| with SILVER metal caps+electricity | | | | |
| 636 112 028 103 | 6 deeper slots (twisted) | 17 | 1527/c | 80 |
| 636 112 028 105 | 6 fine slots (twisted) | 17,4 | 1527/e | 80 |
| 636 122 028 113 | 6 deeper slots (twisted) | 22 | 3966/b | 70 |
| 636 122 028 115 | 6 fine slots (twisted) | 22 | 3966/c | 70 |

CHANDELIER ARM 300

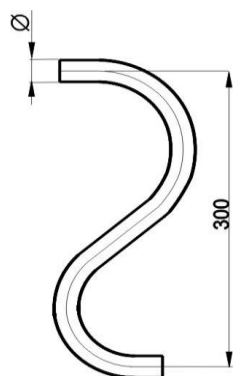

| Code | Outside design | Ø (OD) mm | Drawing SV | Packing (pcs) |
|---|--------------------------------|--------------|---------------|------------------|
| 636 625 030 000 | smooth | 15 | 5142/d | 90 |
| 636 625 030 002 | 6 deeper slots (straight) | 17 | 5142/b | 90 |
| 636 625 030 003 | 6 deeper slots (twisted) | 17 | 5142/c | 90 |
| 636 625 030 004 | 6 fine slots (straight) | 17,4 | 5142 | 90 |
| 636 625 030 005 | 6 fine slots (twisted) | 17,4 | 5142/a | 90 |
| 636 626 030 003 | 6 star profile - deep twisting | 17,6 | 5142/f | 90 |
| 636 626 030 005 | 6 star profile - fine twisting | 17,6 | 5142/g | 90 |
| 636 625 030 012 | 6 deeper slots (straight) | 22 | 3967/c | 60 |
| 636 625 030 013 | 6 deeper slots (twisted) | 22 | 3967/b | 60 |
| 636 625 030 014 | 6 fine slots (straight) | 22 | 3967 | 60 |
| 636 625 030 015 | 6 fine slots (twisted) | 22 | 3967/a | 60 |
| with GOLD metal caps+electricity | | | | |
| 636 111 030 003 | 6 deeper slots (twisted) | 17 | 5142/c | 80 |
| 636 111 030 005 | 6 fine slots (twisted) | 17,4 | 5142/a | 80 |
| 636 121 030 013 | 6 deeper slots (twisted) | 22 | 3967/b | 50 |
| 636 121 030 015 | 6 fine slots (twisted) | 22 | 3967/a | 50 |
| with SILVER metal caps+electricity | | | | |
| 636 112 030 003 | 6 deeper slots (twisted) | 17 | 5142/c | 80 |
| 636 112 030 005 | 6 fine slots (twisted) | 17,4 | 5142/a | 80 |
| 636 122 030 013 | 6 deeper slots (twisted) | 22 | 3967/b | 50 |
| 636 122 030 015 | 6 fine slots (twisted) | 22 | 3967/a | 50 |

CHANDELIER ARM 320

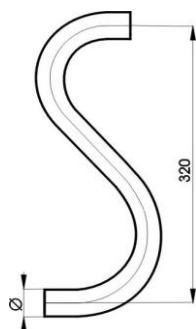

| Code | Outside design | Ø (OD) mm | Drawing SV | Packing (pcs) |
|---|--------------------------------|--------------|---------------|------------------|
| 636 625 032 000 | smooth | 15 | 2356/f | 100 |
| 636 625 032 002 | 6 deeper slots (straight) | 17 | 2356/h | 90 |
| 636 625 032 003 | 6 deeper slots (twisted) | 17 | 2356/ch | 90 |
| 636 625 032 054 | 6 fine slots (straight) | 17,4 | 2356/i | 90 |
| 636 625 032 055 | 6 fine slots (twisted) | 17,4 | 2356/j | 90 |
| 636 626 032 003 | 6 star profile - deep twisting | 17,6 | 2356/k | 90 |
| 636 626 032 055 | 6 star profile - fine twisting | 17,6 | 2356/l | 90 |
| 636 625 032 012 | 6 deeper slots (straight) | 22 | 2356/b | 70 |
| 636 625 032 013 | 6 deeper slots (twisted) | 22 | 2356/a | 70 |
| 636 625 032 014 | 6 fine slots (straight) | 22 | 2356/c | 70 |
| 636 625 032 015 | 6 fine slots (twisted) | 22 | 2356 | 70 |
| with GOLD metal caps+electricity | | | | |
| 636 111 032 003 | 6 deeper slots (twisted) | 17 | 2356/ch | 50 |
| 636 111 032 055 | 6 fine slots (twisted) | 17,4 | 2356/j | 50 |
| 636 121 032 013 | 6 deeper slots (twisted) | 22 | 2356/a | 50 |
| 636 121 032 015 | 6 fine slots (twisted) | 22 | 2356 | 50 |
| with SILVER metal caps+electricity | | | | |
| 636 112 032 003 | 6 deeper slots (twisted) | 17 | 2356/ch | 50 |
| 636 112 032 055 | 6 fine slots (twisted) | 17,4 | 2356/j | 50 |
| 636 122 032 013 | 6 deeper slots (twisted) | 22 | 2356/a | 50 |
| 636 122 032 015 | 6 fine slots (twisted) | 22 | 2356 | 50 |

CHANDELIER ARM 325

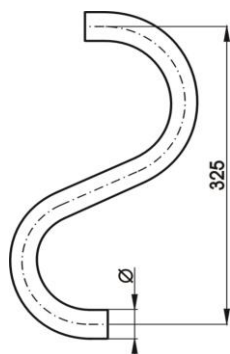

| Code | Outside design | Ø (OD) mm | Drawing SV | Packing (pcs) |
|---|--------------------------------|--------------|---------------|------------------|
| 636 625 032 500 | smooth | 15 | 1528 | 100 |
| 636 625 032 502 | 6 deeper slots (straight) | 17 | 1528/b | 90 |
| 636 625 032 503 | 6 deeper slots (twisted) | 17 | 1528/c | 90 |
| 636 625 032 504 | 6 fine slots (straight) | 17,4 | 1528/d | 90 |
| 636 625 032 505 | 6 fine slots (twisted) | 17,4 | 1528/e | 90 |
| 636 626 032 503 | 6 star profile - deep twisting | 17,6 | 1528/f | 90 |
| 636 626 032 505 | 6 star profile - fine twisting | 17,6 | 1528/g | 90 |
| 636 625 132 522 | 6 deeper slots (straight) | 22 | 2445/b | 70 |
| 636 625 132 523 | 6 deeper slots (twisted) | 22 | 2445/a | 70 |
| 636 625 132 524 | 6 fine slots (straight) | 22 | 2445/c | 70 |
| 636 625 132 525 | 6 fine slots (twisted) | 22 | 2445 | 70 |
| with GOLD metal caps+electricity | | | | |
| 636 111 032 503 | 6 deeper slots (twisted) | 17 | 1528/c | 70 |
| 636 111 032 505 | 6 fine slots (twisted) | 17,4 | 1528/e | 70 |
| 636 121 132 523 | 6 deeper slots (twisted) | 22 | 2445/a | 50 |
| 636 121 132 525 | 6 fine slots (twisted) | 22 | 2445 | 50 |
| with SILVER metal caps+electricity | | | | |
| 636 112 032 503 | 6 deeper slots (twisted) | 17 | 1528/c | 70 |
| 636 112 032 505 | 6 fine slots (twisted) | 17,4 | 1528/e | 70 |
| 636 122 132 523 | 6 deeper slots (twisted) | 22 | 2445/a | 50 |
| 636 122 132 525 | 6 fine slots (twisted) | 22 | 2445 | 50 |

CHANDELIER ARM 325 - 1

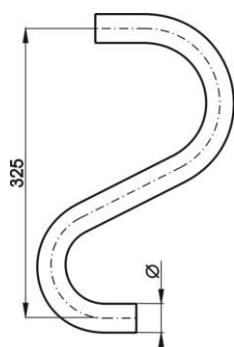

| Code | Outside design | Ø (OD) mm | Drawing SV | Packing (pcs) |
|---|--------------------------------|--------------|---------------|------------------|
| 636 625 132 500 | smooth | 15 | 1532/f | 100 |
| 636 625 132 512 | 6 deeper slots (straight) | 17 | 1532 | 90 |
| 636 625 132 513 | 6 deeper slots (twisted) | 17 | 1532/a | 90 |
| 636 625 132 514 | 6 fine slots (straight) | 17,4 | 1532/b | 90 |
| 636 625 132 515 | 6 fine slots (twisted) | 17,4 | 1532/c | 90 |
| 636 626 132 513 | 6 star profile - deep twisting | 17,6 | 1532/d | 90 |
| 636 626 132 515 | 6 star profile - fine twisting | 17,6 | 1532/e | 90 |
| 636 625 132 502 | 6 deeper slots (straight) | 22 | 3968/c | 70 |
| 636 625 132 503 | 6 deeper slots (twisted) | 22 | 3968 | 70 |
| 636 625 132 504 | 6 fine slots (straight) | 22 | 3968/b | 70 |
| 636 625 132 505 | 6 fine slots (twisted) | 22 | 3968/a | 70 |
| with GOLD metal caps+electricity | | | | |
| 636 111 132 513 | 6 deeper slots (twisted) | 17 | 1532/a | 70 |
| 636 111 132 515 | 6 fine slots (twisted) | 17,4 | 1532/c | 70 |
| 636 121 132 503 | 6 deeper slots (twisted) | 22 | 3968 | 50 |
| 636 121 132 505 | 6 fine slots (twisted) | 22 | 3968/a | 50 |
| with SILVER metal caps+electricity | | | | |
| 636 112 132 513 | 6 deeper slots (twisted) | 17 | 1532/a | 70 |
| 636 112 132 515 | 6 fine slots (twisted) | 17,4 | 1532/c | 70 |
| 636 122 132 503 | 6 deeper slots (twisted) | 22 | 3968 | 50 |
| 636 122 132 505 | 6 fine slots (twisted) | 22 | 3968/a | 50 |

CHANDELIER ARM 350

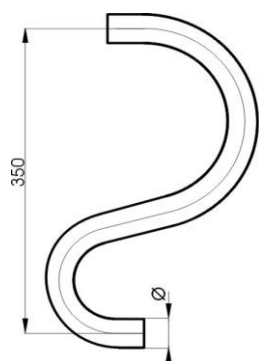

| Code | Outside design | Ø (OD) mm | Drawing SV | Packing (pcs) |
|---|---------------------------------|--------------|---------------|------------------|
| 636 625 035 000 | smooth | 15 | 1339/f | 40 |
| 636 625 035 012 | 6 deeper slots (straight) | 17 | 1339/e | 40 |
| 636 625 035 013 | 6 deeper slots (twisted) | 17 | 1339 | 40 |
| 636 625 035 014 | 6 fine slots (straight) | 17,4 | 1339/d | 40 |
| 636 625 035 015 | 6 fine slots (twisted) | 17,4 | 1339/a | 40 |
| 636 626 035 013 | 6 star profile - deeper twisted | 17,6 | 1339/b | 40 |
| 636 626 035 015 | 6 star profile - fine twisted | 17,6 | 1339/c | 40 |
| 636 625 035 002 | 6 deeper slots (straight) | 22 | 1058/b | 30 |
| 636 625 035 003 | 6 deeper slots (twisted) | 22 | 1058/a | 30 |
| 636 625 035 004 | 6 fine slots (straight) | 22 | 1058/c | 30 |
| 636 625 035 005 | 6 fine slots (twisted) | 22 | 1058 | 30 |
| with GOLD metal caps+electricity | | | | |
| 636 111 035 013 | 6 deeper slots (twisted) | 17 | 1339 | 30 |
| 636 111 035 015 | 6 fine slots (twisted) | 17,4 | 1339/a | 30 |
| 636 121 035 003 | 6 deeper slots (twisted) | 22 | 1058/a | 20 |
| 636 121 035 005 | 6 fine slots (twisted) | 22 | 1058 | 20 |
| with SILVER metal caps+electricity | | | | |
| 636 112 035 013 | 6 deeper slots (twisted) | 17 | 1339 | 30 |
| 636 112 035 015 | 6 fine slots (twisted) | 17,4 | 1339/a | 30 |
| 636 122 035 003 | 6 deeper slots (twisted) | 22 | 1058/a | 20 |
| 636 122 035 005 | 6 fine slots (twisted) | 22 | 1058 | 20 |

CHANDELIER ARM 400

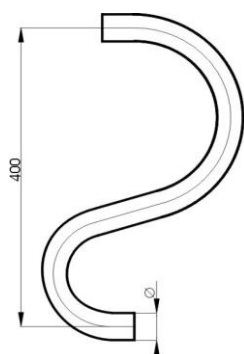

| Code | Outside design | Ø (OD) mm | Drawing SV | Packing (pcs) |
|---|---------------------------------|--------------|---------------|------------------|
| 636 625 040 013 | 6 deeper slots (twisted) | 17 | 2644/b | 30 |
| 636 625 040 015 | 6 fine slots (twisted) | 17,4 | 2644/c | 30 |
| 636 626 040 013 | 6 star profile - deeper twisted | 17,6 | 2644/a | 30 |
| 636 626 040 015 | 6 star profile - fine twisted | 17,6 | 2644 | 30 |
| 636 625 040 002 | 6 deeper slots (straight) | 22 | 1060/b | 20 |
| 636 625 040 003 | 6 deeper slots (twisted) | 22 | 1060/a | 20 |
| 636 625 040 004 | 6 fine slots (straight) | 22 | 1060/c | 20 |
| 636 625 040 005 | 6 fine slots (twisted) | 22 | 1060 | 20 |
| with GOLD metal caps+electricity | | | | |
| 636 111 040 013 | 6 deeper slots (twisted) | 17 | 2644/b | 20 |
| 636 111 040 015 | 6 fine slots (twisted) | 17,4 | 2644/c | 20 |
| 636 121 040 003 | 6 deeper slots (twisted) | 22 | 1060/a | 10 |
| 636 121 040 005 | 6 fine slots (twisted) | 22 | 1060 | 10 |
| with SILVER metal caps+electricity | | | | |
| 636 112 040 013 | 6 deeper slots (twisted) | 17 | 2644/b | 20 |
| 636 112 040 015 | 6 fine slots (twisted) | 17,4 | 2644/c | 20 |
| 636 122 040 003 | 6 deeper slots (twisted) | 22 | 1060/a | 10 |
| 636 122 040 005 | 6 fine slots (twisted) | 22 | 1060 | 10 |

CHANDELIER ARM 445

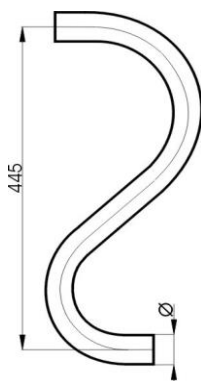

| Code | Outside design | Ø (OD) mm | Drawing SV | Packing (pcs) |
|---|---------------------------|--------------|---------------|------------------|
| 636 625 044 503 | 6 deeper slots (twisted) | 17 | 2357/f | 20 |
| 636 625 044 505 | 6 fine slots (twisted) | 17,4 | 2357/g | 20 |
| 636 625 044 512 | 6 deeper slots (straight) | 22 | 2357/b | 20 |
| 636 625 044 513 | 6 deeper slots (twisted) | 22 | 2357/a | 20 |
| 636 625 044 514 | 6 fine slots (straight) | 22 | 2357/c | 20 |
| 636 625 044 515 | 6 fine slots (twisted) | 22 | 2357 | 20 |
| with GOLD metal caps+electricity | | | | |
| 636 111 044 503 | 6 deeper slots (twisted) | 17 | 2357/f | 20 |
| 636 111 044 505 | 6 fine slots (twisted) | 17,4 | 2357/g | 20 |
| 636 121 044 513 | 6 deeper slots (twisted) | 22 | 2357/a | 10 |
| 636 121 044 515 | 6 fine slots (twisted) | 22 | 2357 | 10 |
| with SILVER metal caps+electricity | | | | |
| 636 112 044 503 | 6 deeper slots (twisted) | 17 | 2357/f | 20 |
| 636 112 044 505 | 6 fine slots (twisted) | 17,4 | 2357/g | 20 |
| 636 122 044 513 | 6 deeper slots (twisted) | 22 | 2357/a | 10 |
| 636 122 044 515 | 6 fine slots (twisted) | 22 | 2357 | 10 |

CHANDELIER ARM 450

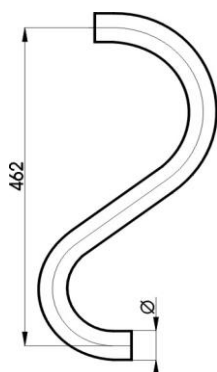

| Code | Outside design | Ø (OD) mm | Drawing SV | Packing (pcs) |
|---|--------------------------------|--------------|---------------|------------------|
| 636 625 045 003 | 6 deeper slots (twisted) | 17 | 3969 | 20 |
| 636 625 045 005 | 6 fine slots (twisted) | 17,4 | 3969/a | 20 |
| 636 626 045 003 | 6 star profile - deep twisting | 17,6 | 3969/b | 20 |
| 636 626 045 005 | 6 star profile - fine twisting | 17,6 | 3969/c | 20 |
| 636 625 045 012 | 6 deeper slots (straight) | 22 | 2274/b | 20 |
| 636 625 045 013 | 6 deeper slots (twisted) | 22 | 2274/a | 20 |
| 636 625 045 014 | 6 fine slots (straight) | 22 | 2274/c | 20 |
| 636 625 045 015 | 6 fine slots (twisted) | 22 | 2274 | 20 |
| with GOLD metal caps+electricity | | | | |
| 636 111 045 003 | 6 deeper slots (twisted) | 17 | 3969 | 20 |
| 636 111 045 005 | 6 fine slots (twisted) | 17,4 | 3969/a | 20 |
| 636 121 045 013 | 6 deeper slots (twisted) | 22 | 2274/a | 10 |
| 636 121 045 015 | 6 fine slots (twisted) | 22 | 2274 | 10 |
| with SILVER metal caps+electricity | | | | |
| 636 112 045 003 | 6 deeper slots (twisted) | 17 | 3969 | 20 |
| 636 112 045 005 | 6 fine slots (twisted) | 17,4 | 3969/a | 20 |
| 636 122 045 013 | 6 deeper slots (twisted) | 22 | 2274/a | 10 |
| 636 122 045 015 | 6 fine slots (twisted) | 22 | 2274 | 10 |

CHANDELIER ARM 520

| Code | Outside design | Ø (OD) mm | Drawing SV | Packing (pcs) |
|---|---------------------------|--------------|---------------|------------------|
| 636 625 052 003 | 6 deeper slots (twisted) | 17 | 4168/c | 30 |
| 636 625 052 005 | 6 fine slots (twisted) | 17,4 | 4168/g | 30 |
| 636 625 052 012 | 6 deeper slots (straight) | 22 | 4168/b | 20 |
| 636 625 052 013 | 6 deeper slots (twisted) | 22 | 4168/a | 20 |
| 636 625 052 014 | 6 fine slots (straight) | 22 | 4168/f | 20 |
| 636 625 052 015 | 6 fine slots (twisted) | 22 | 4168 | 20 |
| with GOLD metal caps+electricity | | | | |
| 636 111 052 003 | 6 deeper slots (twisted) | 17 | 4168/c | 20 |
| 636 111 052 005 | 6 fine slots (twisted) | 17,4 | 4168/g | 20 |
| 636 121 052 013 | 6 deeper slots (twisted) | 22 | 4168/a | 20 |
| 636 121 052 015 | 6 fine slots (twisted) | 22 | 4168 | 20 |
| with SILVER metal caps+electricity | | | | |
| 636 112 052 003 | 6 deeper slots (twisted) | 17 | 4168/c | 20 |
| 636 112 052 005 | 6 fine slots (twisted) | 17,4 | 4168/g | 20 |
| 636 122 052 013 | 6 deeper slots (twisted) | 22 | 4168/a | 20 |
| 636 122 052 015 | 6 fine slots (twisted) | 22 | 4168 | 20 |

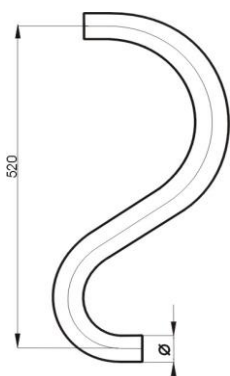

CHANDELIER ARM 620

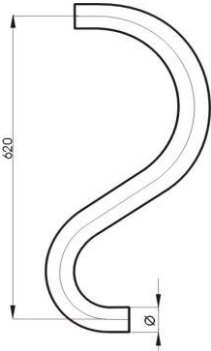

| Code | Outside design | Ø (OD) mm | Drawing SV | Packing (pcs) |
|---|---------------------------|--------------|---------------|------------------|
| 636 625 062 012 | 6 deeper slots (straight) | 22 | 4512/a | 20 |
| 636 625 062 013 | 6 deeper slots (twisted) | 22 | 4512 | 20 |
| 636 625 062 014 | 6 fine slots (straight) | 22 | 4512/c | 20 |
| 636 625 062 015 | 6 fine slots (twisted) | 22 | 4512/b | 20 |
| with GOLD metal caps+electricity | | | | |
| 636 121 062 013 | 6 deeper slots (twisted) | 22 | 4512 | 20 |
| 636 121 062 015 | 6 fine slots (twisted) | 22 | 4512/b | 20 |
| with SILVER metal caps+electricity | | | | |
| 636 122 062 013 | 6 deeper slots (twisted) | 22 | 4512 | 20 |
| 636 122 062 015 | 6 fine slots (twisted) | 22 | 4512/b | 20 |

CHANDELIER ARM 720

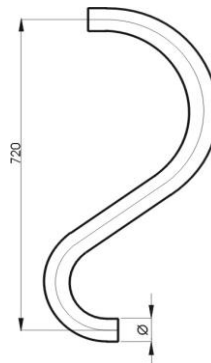

| Code | Outside design | Ø (OD) mm | Drawing SV | Packing (pcs) |
|---|---------------------------|--------------|---------------|------------------|
| 636 625 072 022 | 6 deeper slots (straight) | 22 | 5066/1 | 20 |
| 636 625 072 023 | 6 deeper slots (twisted) | 22 | 5066 | 20 |
| 636 625 072 024 | 6 fine slots (straight) | 22 | 5066/3 | 20 |
| 636 625 072 025 | 6 fine slots (twisted) | 22 | 5066/2 | 20 |
| with GOLD metal caps+electricity | | | | |
| 636 121 072 023 | 6 deeper slots (twisted) | 22 | 5066 | 20 |
| 636 121 072 025 | 6 fine slots (twisted) | 22 | 5066/2 | 20 |
| with SILVER metal caps+electricity | | | | |
| 636 122 072 023 | 6 deeper slots (twisted) | 22 | 5066 | 20 |
| 636 122 072 025 | 6 fine slots (twisted) | 22 | 5066/2 | 20 |

COATING OF CHANDELIER ARMS

- 799 000 200 251 Gold coating of chandelier arms
(max. size of chandelier arms 325 mm)
- 799 000 200 252 Silver coating of chandelier arms
(max. size of chandelier arms 325 mm)

WIRING

We can offer you a delivery of wiring with all offered diametres of chandelier arms. Wiring contains a plastic socket with a small screw, a cable and a nut.

PLASTERING AND COATING OF CHANDELIER ARMS

Basic options of coating are front and back - front with one front hole.

In case that the order includes a delivery of wiring, there is always a washer for the centring of the bowl on the front coating of chandelier arms diameter 17 and 17,4 mm - with 1 hole, on the chandelier arms diameter 22 mm is this washer without a hole.

There is serrated nut on the back coating of the chandelier arm.

If our coating doesn't satisfy your requirements, we accept yours.

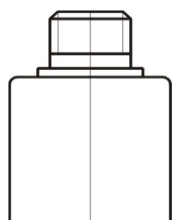
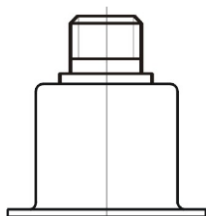

| Code | Outside design | Ø (OD) Ch.arm | Ø (OD) metal |
|-----------------|--|------------------|-----------------|
| 799 000 300 017 | Plastering - one side | 17,4 | 20 |
| 799 000 200 204 | Plastering - both sides | 17,4 | 20 |
| 799 000 200 206 | Plastering + coating GOLD front: pressed, acidwashed lacquered back: pressed, polished lacquered | 17,4 | 20 |
| 799 000 200 230 | Plastering + coating GOLD including centring washer front: pressed, acidwashed lacquered back: pressed, polished lacquered | 17,4 | 20 |
| 799 000 300 001 | Plastering + coating GOLD only front: pressed, acidwashed lacquered | 17,4 | 20 |
| 799 000 300 101 | Plastering + coating GOLD only back: pressed, polished lacquered | 17,4 | 20 |
| 799 000 200 218 | Plastering + coating GOLD 2x back: pressed, polished lacquered | 17,4 | 20 |
| 799 000 200 208 | Plastering + coating SILVER front: pressed, silvered lacquered back: pressed, polished silvered lacquered | 17,4 | 20 |
| 799 000 200 228 | Plastering + coating SILVER including centring washer front: pressed, silvered lacquered back: pressed, polished silvered lacquered | 17,4 | 20 |
| 799 000 300 000 | Plastering + coating SILVER only front: pressed, silvered lacquered | 17,4 | 20 |
| 799 000 300 100 | Plastering + coating SILVER only back: pressed, polished silvered lacquered | 17,4 | 20 |
| 799 000 300 099 | Plastering + coating SILVER 2x back: pressed, polished silvered lacquered | 17,4 | 20 |

| Code | Outside design | Ø (OD) Ch.arm | Ø (OD) metal |
|-----------------|---|------------------|-----------------|
| 799 000 300 022 | Plastering - one side | 22 | 25 |
| 799 000 300 023 | Plastering - both sides | 22 | 25 |
| 799 000 200 214 | Plastering + coating GOLD front: pressed, acidwashed lacquered back: wholetwisted, polished lacquered | 22 | 25 |
| 799 000 200 229 | Plastering + coating GOLD incl.centring washer front: pressed, acidwashed lacquered back: wholetwisted, polished lacquered | 22 | 25 |
| 799 000 300 012 | Plastering + coating GOLD only front: pressed, acidwashed lacquered | 22 | 25 |
| 799 000 300 102 | Plastering + coating GOLD only back: wholetwisted, polished lacquered | 22 | 25 |
| 799 000 200 216 | Plastering + coating SILVER front: pressed, silvered lacquered back: wholetwisted, polished silvered lacquered | 22 | 25 |
| 799 000 200 226 | Plastering + coating SILVER incl.centring washer front: pressed, silvered lacquered back: wholetwisted, polished silvered lacquered | 22 | 25 |
| 799 000 300 013 | Plastering + coating SILVER only front: pressed, silvered lacquered | 22 | 25 |
| 799 000 300 103 | Plastering + coating SILVER only back: wholetwisted, polished silvered lacquered | 22 | 25 |

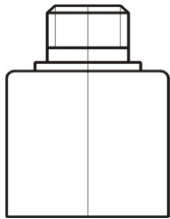
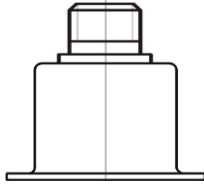

CHANDELIER COMPONENTS

SILIQUA - clear

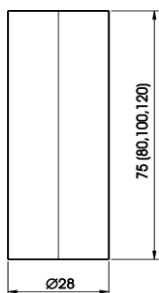

| Code | Ø (OD) x length (mm) | Drawing SV | Packing (pcs) |
|-----------------|----------------------|------------|---------------|
| 632 634 328 075 | 28 x 75 | 3998 | 200 |
| 632 634 328 080 | 28 x 80 | 3998 | 200 |
| 632 634 328 100 | 28 x 100 | 3998 | 200 |
| 632 634 328 120 | 28 x 120 | 3998 | 200 |
| 632 634 329 360 | 32 x 60 | 3999 | 150 |
| 632 634 329 370 | 32 x 70 | 3999 | 150 |
| 632 634 329 395 | 32 x 95 | 3999 | 150 |
| 632 634 329 398 | 32 x 120 | 3999 | 150 |

SILQUA - milk

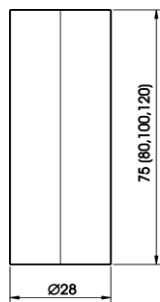

| Code | Ø (OD) x length (mm) | Drawing SV | Packing (pcs) |
|-----------------|----------------------|------------|---------------|
| 632 634 528 055 | 28 x 55 | 5344 | 508 |
| 632 634 528 060 | 28 x 60 | 5344 | 508 |
| 632 634 528 065 | 28 x 65 | 5344 | 508 |
| 632 634 528 070 | 28 x 70 | 5344 | 508 |
| 632 634 528 075 | 28 x 75 | 5344 | 508 |
| 632 634 528 080 | 28 x 80 | 5344 | 381 |
| 632 634 528 085 | 28 x 85 | 5344 | 381 |
| 632 634 528 090 | 28 x 90 | 5344 | 381 |
| 632 634 528 095 | 28 x 95 | 5344 | 381 |
| 632 634 528 100 | 28 x 100 | 5344 | 381 |

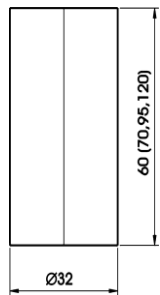

| | | | |
|-----------------|----------|------|-----|
| 632 634 532 055 | 32 x 55 | 5345 | 500 |
| 632 634 532 060 | 32 x 60 | 5345 | 500 |
| 632 634 532 062 | 32 x 62 | 5345 | 500 |
| 632 634 532 065 | 32 x 65 | 5345 | 400 |
| 632 634 532 068 | 32 x 68 | 5345 | 400 |
| 632 634 532 070 | 32 x 70 | 5345 | 400 |
| 632 634 532 072 | 32 x 72 | 5345 | 400 |
| 632 634 532 074 | 32 x 74 | 5345 | 400 |
| 632 634 532 078 | 32 x 78 | 5345 | 400 |
| 632 634 532 080 | 32 x 80 | 5345 | 400 |
| 632 634 532 084 | 32 x 84 | 5345 | 300 |
| 632 634 532 088 | 32 x 88 | 5345 | 300 |
| 632 634 532 090 | 32 x 90 | 5345 | 300 |
| 632 634 532 095 | 32 x 95 | 5345 | 300 |
| 632 634 532 100 | 32 x 100 | 5345 | 300 |
| 632 634 532 120 | 32 x 120 | 5345 | 200 |
| 632 634 532 150 | 32 x 150 | 5345 | 200 |
| 632 634 532 175 | 32 x 175 | 5345 | 100 |
| 632 634 532 200 | 32 x 200 | 5345 | 100 |

SILQUA - gold coated

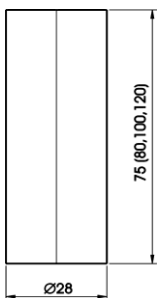

| Code | Ø (OD) x length (mm) | Drawing SV | Packing (pcs) |
|-----------------|----------------------|------------|---------------|
| 632 634 328 076 | 28 x 75 | 3998 | 200 |
| 632 634 328 086 | 28 x 80 | 3998 | 200 |
| 632 634 328 106 | 28 x 100 | 3998 | 200 |
| 632 634 328 126 | 28 x 120 | 3998 | 200 |

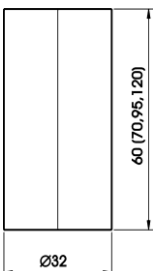

| | | | |
|-----------------|----------|------|-----|
| 632 634 329 366 | 32 x 60 | 3999 | 150 |
| 632 634 329 376 | 32 x 70 | 3999 | 150 |
| 632 634 329 396 | 32 x 95 | 3999 | 150 |
| 632 634 329 406 | 32 x 120 | 3999 | 150 |

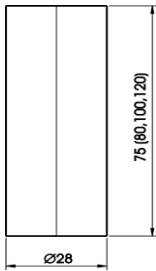

SILIQUA - silver coated

| Code | Ø (OD) x length (mm) | Drawing SV | Packing (pcs) |
|-----------------|----------------------|------------|---------------|
| 632 634 328 077 | 28 x 75 | 3998 | 200 |
| 632 634 328 087 | 28 x 80 | 3998 | 200 |
| 632 634 328 107 | 28 x 100 | 3998 | 200 |
| 632 634 328 127 | 28 x 120 | 3998 | 200 |
| 632 634 329 367 | 32 x 60 | 3999 | 150 |
| 632 634 329 377 | 32 x 70 | 3999 | 150 |
| 632 634 329 397 | 32 x 95 | 3999 | 150 |
| 632 634 329 407 | 32 x 120 | 3999 | 150 |

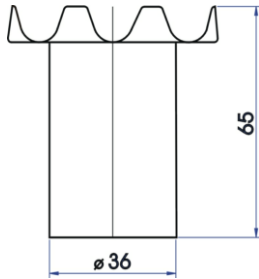
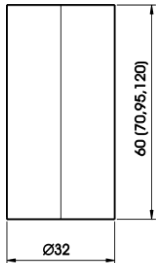

SOCKET COVER

| Code | Ø (OD) x length (mm) | Drawing SV | Packing (pcs) |
|-----------------|----------------------|------------|---------------|
| 746 861 304 400 | 36 x 65 | 1106 | 300 |
| 746 861 305 100 | 37 x 90 | 1106/1 | 250 |

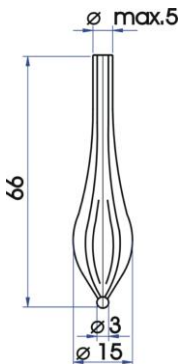

DROP "TEAR"

| Code | Ø (OD) x length (mm) | Drawing SV | Packing (pcs) |
|-----------------|----------------------|------------|---------------|
| 746 862 000 000 | 15 x 66 | 1618 | 500 |

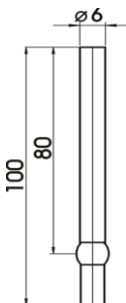

DECORATIVE ROD

| Code | Ø (OD) x length (mm) | Drawing SV | Packing (pcs) |
|-----------------|----------------------|------------|---------------|
| 632 522 206 551 | 6 x 100 mm / 50 | 1619 | 400 |
| 632 522 206 581 | 6 x 100 mm / 80 | 1620 | 400 |

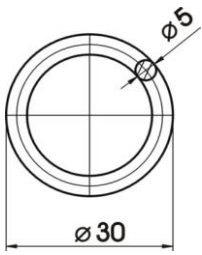

JOINING RING

| Code | Ø (OD) x length (mm) | Drawing SV | Packing (pcs) |
|-----------------|----------------------|------------|---------------|
| 746 860 850 006 | 30 x 20 | 1621.1 | 800 |
| 746 860 850 000 | 40 x 30 | 1622 | 500 |
| 746 860 850 007 | 43 x 33 | 3970 | 500 |

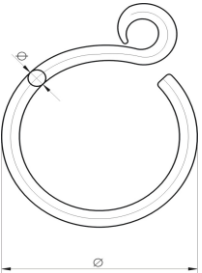

JOINING RING with small ring

| Code | Ø (OD) x length (mm) | Drawing SV | Packing (pcs) |
|-----------------|----------------------|------------|---------------|
| 636 000 000 055 | 55 x 45 | 5227 | 100 |
| 636 000 000 065 | 65 x 55 | 5228 | 100 |

Trimming - deeper slots (twisted)

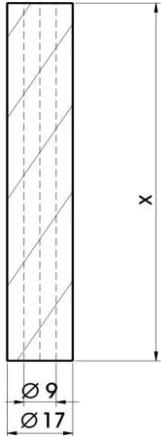

| Code | Ø (OD) x length (mm) | Drawing SV | Packing (pcs) |
|-----------------|----------------------|------------|---------------|
| 746 861 309 301 | 17 x 30 | 3975 | 100 |
| 746 861 309 101 | 17 x 40 | 3975 | 100 |
| 746 861 309 401 | 17 x 50 | 3975 | 100 |
| 746 861 309 201 | 17 x 60 | 3975 | 100 |
| 746 861 303 801 | 17 x 70 | 3975 | 100 |
| 746 861 309 491 | 17 x 90 | 3975 | 100 |
| 746 861 304 411 | 17 x 100 | 3975 | 100 |
| 746 861 302 400 | 17 x 150 | 3975 | 100 |
| 746 861 302 100 | 17 x 200 | 3975 | 100 |
| 746 861 302 200 | 17 x 250 | 3975 | 100 |
| 746 861 302 300 | 17 x 300 | 3975 | 100 |
| 746 861 302 500 | 17 x 350 | 3975 | 100 |

Trimming - fine slots (twisted)

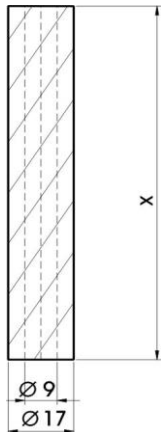

| Code | Ø (OD) x length (mm) | Drawing SV | Packing (pcs) |
|-----------------|----------------------|------------|---------------|
| 746 861 309 300 | 17 x 30 | 3974 | 100 |
| 746 861 309 100 | 17 x 40 | 3974 | 100 |
| 746 861 309 400 | 17 x 50 | 3974 | 100 |
| 746 861 309 200 | 17 x 60 | 3974 | 100 |
| 746 861 303 800 | 17 x 70 | 3974 | 100 |
| 746 861 309 490 | 17 x 90 | 3974 | 100 |
| 746 861 304 410 | 17 x 100 | 3974 | 100 |
| 746 861 301 400 | 17 x 150 | 3974 | 100 |
| 746 861 301 100 | 17 x 200 | 3974 | 100 |
| 746 861 301 200 | 17 x 250 | 3974 | 100 |
| 746 861 301 300 | 17 x 300 | 3974 | 100 |
| 746 861 301 500 | 17 x 350 | 3974 | 100 |

Trimming - deeper slots (twisted)

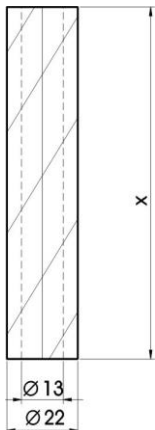

| Code | Ø (OD) x length (mm) | Drawing SV | Packing (pcs) |
|-----------------|----------------------|------------|---------------|
| 746 861 304 231 | 22 x 30 | 3973 | 100 |
| 746 861 303 701 | 22 x 40 | 3973 | 100 |
| 746 861 303 601 | 22 x 50 | 3973 | 100 |
| 746 861 304 261 | 22 x 60 | 3973 | 100 |
| 746 861 304 271 | 22 x 70 | 3973 | 100 |
| 746 861 303 090 | 22 x 90 | 3973 | 100 |
| 746 861 303 010 | 22 x 100 | 3973 | 100 |
| 746 861 304 316 | 22 x 150 | 3973 | 100 |
| 746 861 304 321 | 22 x 200 | 3973 | 100 |
| 746 861 304 326 | 22 x 250 | 3973 | 100 |
| 746 861 304 331 | 22 x 300 | 3973 | 100 |
| 746 861 304 336 | 22 x 350 | 3973 | 100 |

Trimming - fine slots (straight)

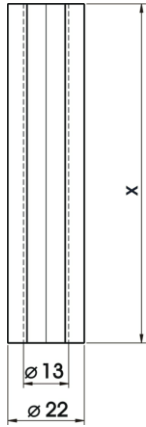

| Code | Ø (OD) x length (mm) | Drawing SV | Packing (pcs) |
|-----------------|----------------------|------------|---------------|
| 746 861 304 210 | 22 x 10 | 1639 | 100 |
| 746 861 304 215 | 22 x 15 | 1639 | 100 |
| 746 861 304 220 | 22 x 20 | 1639 | 100 |
| 746 861 304 225 | 22 x 25 | 1639 | 100 |
| 746 861 304 230 | 22 x 30 | 1639 | 100 |
| 746 861 304 235 | 22 x 35 | 1639 | 100 |
| 746 861 304 200 | 22 x 40 | 1639 | 100 |
| 746 861 304 100 | 22 x 50 | 1639 | 100 |
| 746 861 304 260 | 22 x 60 | 1639 | 100 |
| 746 861 304 700 | 22 x 75 | 1639 | 100 |
| 746 861 304 290 | 22 x 90 | 1639 | 100 |
| 746 861 304 300 | 22 x 100 | 1639 | 100 |
| 746 861 304 315 | 22 x 150 | 1639 | 100 |
| 746 861 304 317 | 22 x 175 | 1639 | 100 |
| 746 861 304 320 | 22 x 200 | 1639 | 100 |
| 746 861 304 325 | 22 x 250 | 1639 | 100 |
| 746 861 304 330 | 22 x 300 | 1639 | 100 |
| 746 861 304 332 | 22 x 320 | 1639 | 100 |
| 746 861 304 335 | 22 x 350 | 1639 | 100 |

Trimming - fine slots (twisted)

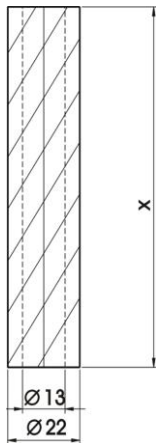

| Code | Ø (OD) x length (mm) | Drawing SV | Packing (pcs) |
|-----------------|----------------------|------------|---------------|
| 746 861 311 100 | 22 x 10 | 1636 | 100 |
| 746 861 311 200 | 22 x 15 | 1636 | 100 |
| 746 861 311 300 | 22 x 20 | 1636 | 100 |
| 746 861 304 600 | 22 x 25 | 1636 | 100 |
| 746 861 310 300 | 22 x 30 | 1636 | 100 |
| 746 861 310 350 | 22 x 35 | 1636 | 100 |
| 746 861 303 700 | 22 x 40 | 1636 | 100 |
| 746 861 303 600 | 22 x 50 | 1636 | 100 |
| 746 861 310 400 | 22 x 60 | 1636 | 100 |
| 746 861 310 100 | 22 x 75 | 1636 | 100 |
| 746 861 307 000 | 22 x 90 | 1636 | 100 |
| 746 861 303 000 | 22 x 100 | 1636 | 100 |
| 746 861 303 400 | 22 x 150 | 1636 | 100 |
| 746 861 310 200 | 22 x 175 | 1636 | 100 |
| 746 861 303 100 | 22 x 200 | 1636 | 100 |
| 746 861 303 200 | 22 x 250 | 1636 | 100 |
| 746 861 303 300 | 22 x 300 | 1636 | 100 |
| 746 861 303 900 | 22 x 320 | 1636 | 100 |
| 746 861 303 500 | 22 x 350 | 1636 | 100 |

ROLLER

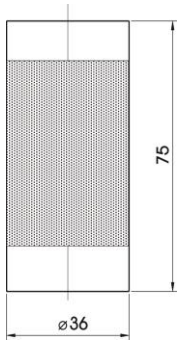

Roller with partial sandblasting

| Code | Ø (OD) x length (mm) | Drawing SV | Packing (pcs) |
|-----------------|----------------------|------------|---------------|
| 632 634 336 076 | 36 x 75 | 3940 | 250 |

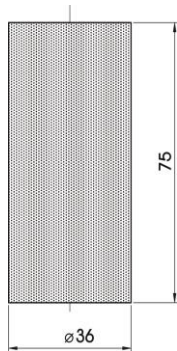

Roller with full sandblasting

| Code | Ø (OD) x length (mm) | Drawing SV | Packing (pcs) |
|-----------------|----------------------|------------|---------------|
| 632 634 336 075 | 36 x 75 | 3971 | 250 |

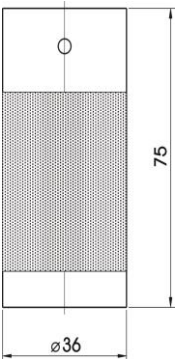

Roller with partial sandblasting and 2 holes

| Code | Ø (OD) x length (mm) | Drawing SV | Packing (pcs) |
|-----------------|----------------------|------------|---------------|
| 632 634 336 077 | 36 x 75 | 3972 | 250 |

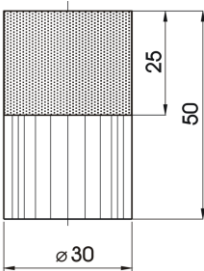

Roller with partial sandblasting and inside knurling

| Code | Ø (OD) x length (mm) | Drawing SV | Packing (pcs) |
|-----------------|----------------------|------------|---------------|
| 632 634 230 050 | 30 x 50 | 3956 | 300 |

